

▶ Vertical Liquid Receivers



▶ Horizontal & Vertical Liquid Receivers



▶ Deep Drawn Vertical Liquid Receivers



LIQUID RECEIVERS



▶ Horizontal Liquid Receivers



▶ Horizontal Liquid Receivers
With BasePlate For Compressor



Product introduction ;

Liquid receivers are used to compensate the fluctuations in the system, generally at the high-pressure side of the system.

They function as a buffer/cushion between the liquid and the heated gas.

They are also used to prevent the heated gas from going to the evaporator; besides, they let the liquid in the system refresh.

They are placed between the condenser and the compressor in the refrigeration units.

Liquid receivers should be sized in accordance with the amount of the refrigerant fluid in the facility.

They can be used with every kind of refrigerant in every kind of refrigeration system where refrigerant storage is necessary.

It is momentarily advisable to use safety relief valves in liquid receivers and rotolock valves in inlet and outlet connections.

Liquid receivers are produced in accordance with the CE 97/23/EC directive.

Note;

Consulting our catalogue, it's advisable considering that the storage maximum volume shall be the 80% of the volume.

All products are manufactured with materials, procedures and test in according to PED 97/23/EC Directive and to EN 14276-1

Technical Data



Code Numbers; HLR-9A-F/F-90x3

- **HLR-9A-F/F-90x3** - Horizontal Liquid Receivers.
- **HLR-9A-F/F-90x3** - Diameter of products
- **HLR-9A-F/F-90x3** - Design of products
- **HLR-9A-F/F-90x3** - Inlet and outlet Flare connection (if you need solder connections you should change the F/F to S/S)

Forexample if need inlet solder and outlet flare connection the code number must be VLR-9A-S/F-90x3

- **HLR-9A-F/F-90x3** - Volume of products
- **HLR-9A-F/F-90x3** - Quantity of Sight glasses

P.S: Please contact us for further information.

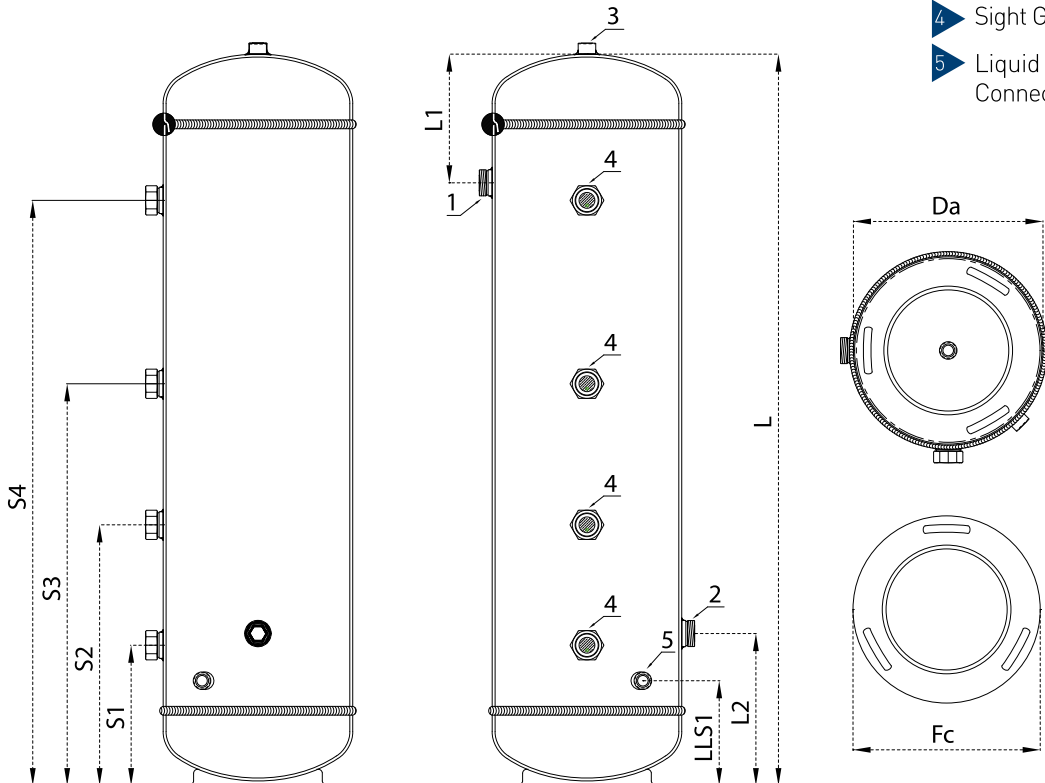

- 1 Inlet Connection
- 2 Outlet Connection
- 3 Safety Valve Connection
- 4 Sight Glass (optional)
- 5 Liquid Level Sensor Connection (optional)

VERTICAL LIQUID RECEIVERS



The following list includes standard products only.

Upon special request, these standard products can be modified according to the Directive 97/23/EC.

- Sight glass may be reduced or increased according to the requirement.
- Sight glasses may be produced in various dimensions according to the requirement.
- Inlet & Outlet connections can be used in various dimensions and features according to the requirement.
- Liquid level sensor connections can be used according to the requirement. 1/2" NPT connection is used as standard.

However, LLS-01 model that is supplied by us uses M20x1.5 coupling sleeves.

Please see the page 45 for further information about the product.

- Different coupling sleeves may be used according to the safety valve that you will use and its connection.

- Products in different volume and design may be produced upon request.

Please contact us for further detail.

Model	Volume (Lt)	Diameter	Dimensions				Connections			Type	Sight Glasses				CE					
			L (mm)	L1 (mm)	L2 (mm)	Fc (mm)	Sv (Inch)	Inlet (Inch)	Outlet (Inch)		S1 (mm)	S2 (mm)	S3 (mm)	S4 (mm)	PED 32 Bar	97/23/EC 45 Bar				
VLR-5A-F/F-04x1	4	Ø140	310	85	140	Ø 135 (VFC-135)	-	1"-14 UNS	1"-14 UNS	SW36 Screw Sight Glass	120	-	-	-	CAT I A1	CAT I/A1				
VLR-5A-F/F-05x1	5		380								120	-	-	-						
VLR-6A-F/F-06x1	6		340								130	-	-	-						
VLR-6A-F/F-07x1	7		380								130	-	-	-						
VLR-6A-F/F-08x1	8	Ø165	450	90	150	Ø 161 (VFC-161)	1/2" NPTF	1"-14 UNS	1"-14 UNS		130	-	-	-	CAT I A1	CAT II A1				
VLR-6A-F/F-09x1	9		500								130	-	-	-						
VLR-6A-F/F-10x1	10		540								130	-	-	-						
VLR-6A-F/F-12x2	12		650								130	530	-	-						
VLR-7A-F/F-14x1	14	Ø219	430	130	200	Ø 182 (VFC-182)	1/2" NPTF	1"-14 UNS	1"-14 UNS		210	-	-	-			B + C1 CAT II/A1	CAT III B + C1		
VLR-7A-F/F-16x1	16		490								210	-	-	-						
VLR-7A-F/F-18x1	18		550							210	-	-	-							
VLR-7A-F/F-20x2	20		620							210	450	-	-							
VLR-7A-F/F-25x2	25		760	150	12 UNF	1 1/4"- 12 UNF	210	590	-	-	230	780	-	-						
VLR-7A-F/F-30x2	30		900				230	530	880	-										
VLR-7A-F/F-35x3	35		1050				230	530	880	-										
VLR-8A-F/F-30x1	30		580				230	-	-	-										
VLR-8A-F/F-35x2	35		Ø273	680	180	250	Ø 249 (VFC-249)	1/2" NPTF	1"-14 12 UNF	1 1/4"- 12 UNF	230	480	-	-	CAT III B + C1	CAT IV B + D				
VLR-8A-F/F-40x2	40			780							230	580	-	-						
VLR-8A-F/F-45x2	45	870		260							670	-	-							
VLR-8A-F/F-50x2	50	970		260							770	-	-							
VLR-8A-F/F-60x3	60	1160		13/4"- 12 UNS	13/4"- 12 UNS	260	560	960	-	CAT III B + C1	CAT IV B + D									
VLR-8A-F/F-70x3	70	1350				260	660	1150	-											
VLR-8A-F/F-80x3	80	1540				260	760	1340	-											
VLR-9A-F/F-45x1	45	630				220	-	-	-											
VLR-9A-F/F-50x2	50	Ø324		700	240	Ø 320 (VFC-320)	1/2" NPTF	1 3/4"- 12 UNS	1 3/4"- 12 UNS			220	470	-			-	CAT III B + C1	CAT III B + C1	
VLR-9A-F/F-60x2	60			840								240	660	-			-			
VLR-9A-F/F-70x2	70		960	240								710	-	-						
VLR-9A-F/F-80x3	80		1110	240								540	860	-						
VLR-9A-F/F-90x3	90		1250	240	560	1000	-													
VLR-9A-F/F-100x3	100		1400	240	640	1150	-													
VLR-10A-F/F-100x3	100	Ø406	900	250	330	Ø 430 (VFC-430)	1/2" NPTF	2 1/4"- 12 UN	2 1/4"- 12 UN	21 1/4" Rotolock Sight Glass	280	640	-	-	CAT IV B + D	CAT III B + C1				
VLR-10A-F/F-125x3	125		1110								280	530	850	-						
VLR-10A-F/F-150x3	150		1330								280	630	1070	-						
VLR-11A-F/F-175x3	175		1270								300	600	950	-						
VLR-11A-F/F-200x3	200	Ø450	1450	280	330	Ø 480 (VFC-480)	1/2" NPTF	2 1/4"- 12 UN	2 1/4"- 12 UN		300	650	1130	-			CAT IV B + D	CAT III B + C1		
VLR-11A-F/F-225x3	225		1620								300	750	1300	-						
VLR-12A-F/F-250x3	250		1450								300	650	1150	-						
VLR-12A-F/F-300x3	300		1750								300	750	1450	-						
VLR-12A-F/F-350x3	350	Ø508	2000	300	380	Ø 550 (VFC-550)	1/2" NPTF	2 1/4"- 12 UN	2 1/4"- 12 UN		350	650	1150	1700					CAT IV B + D	CAT III B + C1
VLR-12A-F/F-400x3	400		2300								350	750	1350	2000						
VLR-13A-F/F-450x4	450		1800							400	700	1000	1400							
VLR-13A-F/F-500x4	500		2000							350	450	Ø 650 (VFC-650)	1/2" NPTF	ODS 76	ODS 76	400				
VLR-13A-F/F-550x4	550	Ø600	2200	350	450	Ø 650 (VFC-650)	1/2" NPTF	ODS 76	ODS 76	400	750	1200	1800	CAT IV B + D	CAT III B + C1					

HORIZONTAL LIQUID RECEIVERS

Technical Data



Code Numbers: HLR-9A-F/F-90x3

- **HLR-9A-F/F-90x3** - Horizontal Liquid Receivers.
- **HLR-9A-F/F-90x3** - Diameter of products
- **HLR-9A-F/F-90x3** - Design of products
- **HLR-9A-F/F-90x3** - Inlet and outlet Flare connection (if you need solder connections you should change the F/F to S/S)

Forexample if need inlet solder and outlet flare connection the code number must be VLR-9A-S/F-90x3

- **HLR-9A-F/F-90x3** - Volume of products
- **HLR-9A-F/F-90x3** - Quantity of Sight glasses

P.S: Please contact us for further information.

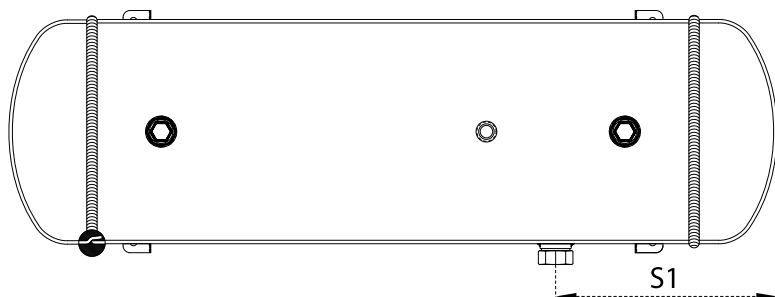
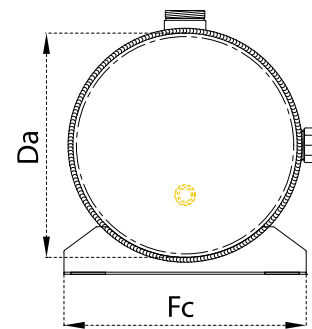
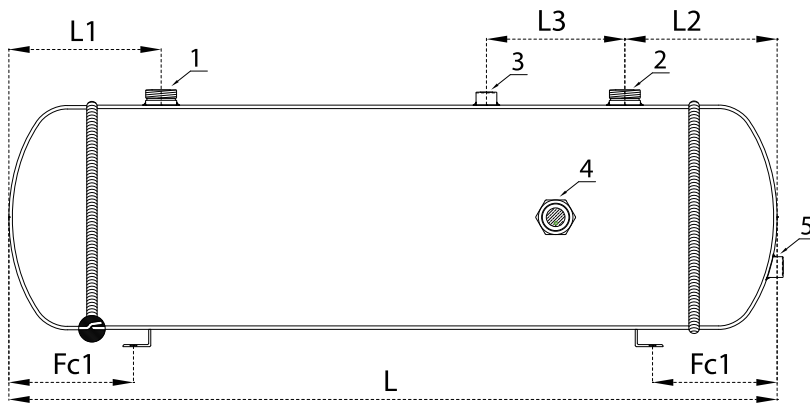

- 1 Inlet Connection
- 2 Outlet Connection
- 3 Safety Valve Connection
- 4 Sight Glass (optional)
- 5 Liquid Level Sensor Connection (optional)

HORIZONTAL LIQUID RECEIVERS



The following list includes standard products only.

Upon special request, these standard products can be modified according to the Directive 97/23/EC.

- Sight glass may be reduced or increased according to the requirement.
- Sight glasses may be produced in various dimensions according to the requirement.
- Inlet & Outlet connections can be used in various dimensions and features according to the requirement.
- Liquid level sensor connections can be used according to the requirement. 1/2" NPT connection is used as standard. However, LLS-01 model that is supplied by us uses M20x1.5 coupling sleeves.

Please see the page 45 for further information about the product.

- Different coupling sleeves may be used according to the safety valve that you will use and its connection.

- Products in different volume and design may be produced upon request.

Please contact us for further detail.

Model	Volume (Lt)	Diameter	Dimensions						Connections			Type	Sight Glass	CE	
			L (mm)	L1 (mm)	L2 (mm)	L3 (mm)	Fc1 (mm)	Fc (mm)	Sv (Inch)	Inlet (Inch)	Outlet (Inch)		S1 (mm)	PED 32 Bar	97/23/EC 45 Bar
HLR-5A-F/F-04x1	4	140	310	85	85	-	70	155 (HFC-155)	-	1"-14 UNS	1"-14 UNS	SW36 Screw Sight Glass	145	CAT I A1	CAT I A1
HLR-5A-F/F-05x1	5		380												
HLR-6A-F/F-06x1	6		340	80	80								150	CAT I A1	CAT II A1
HLR-6A-F/F-07x1	7		380			A_80									
HLR-6A-F/F-08x1	8		450												
HLR-6A-F/F-09x1	9		500	100	100		70	175 (HFC-175)	1/2" NPTF	1"-14 UNS	1"-14 UNS		180		
HLR-6A-F/F-10x1	10		540			100									
HLR-6A-F/F-12x1	12		650												
HLR-7A-F/F-14x1	14		430												
HLR-7A-F/F-16x1	16		490	120	120	A_120				1"-14 UNS	1"-14 UNS		200		
HLR-7A-F/F-18x1	18		550												
HLR-7A-F/F-20x1	20		620			150						1 3/4" Rotolock Sight Glass	240	B + C1	
HLR-7A-F/F-25x1	25		760	140	140	200	120	240 (HFC-240)	1/2" NPTF	1 1/4"-12 UNF	1 1/4"-12 UNF				
HLR-7A-F/F-30x1	30		900											CAT II / A1	CAT III B + C1
HLR-7A-F/F-35x1	35		1050												
HLR-8A-F/F-30x1	30		580	150	150	140				1 1/4"-12 UNF			220		
HLR-8A-F/F-35x1	35		680								1 1/4"-12 UNF				
HLR-8A-F/F-40x1	40		780			180							270	CAT III B + C1	CAT IV B + D
HLR-8A-F/F-45x1	45		870												
HLR-8A-F/F-50x1	50		960	180	180		150	300 (HFC-300)	1/2" NPTF	1 3/4"-12 UNS			300		
HLR-8A-F/F-60x1	60		1160								1 3/4"-12 UNS				
HLR-8A-F/F-70x1	70		1350			220									
HLR-8A-F/F-80x1	80		1540												
HLR-9A-F/F-45x1	45		630	170	170	140					1 1/4"-12 UNF	2 1/4" Rotolock Sight Glass	240	CAT III B + C1	CAT III B + C1
HLR-9A-F/F-50x1	50		700	180	180	170							260		
HLR-9A-F/F-60x1	60		840							1 3/4"-12 UNS			300		
HLR-9A-F/F-70x1	70		960				180	350 (HFC-350)	1/2" NPTF		1 3/4"-12 UNS		320	CAT IV B + D	CAT IV B + D
HLR-9A-F/F-80x1	80		1110	220	220	200				2 1/4"-12 UN					
HLR-9A-F/F-90x1	90		1250										350		
HLR-9A-F/F-100x1	100		1400												
HLR-10A-F/F-100x1	100		900			200						2 1/4" Rotolock Sight Glass	330	CAT IV B + D	CAT IV B + D
HLR-10A-F/F-125x1	125		1110	230	230	250	220	450 (HFC-450)	1/2" NPTF	2 1/4"-12 UN	2 1/4"-12 UN		350		
HLR-10A-F/F-150x1	150		1330												
HLR-11A-F/F-175x1	175		1270												
HLR-11A-F/F-200x1	200		1450	250	250	300	250	500 (HFC-500)	1/2" NPTF	2 1/4"-12 UN	2 1/4"-12 UN		400		
HLR-11A-F/F-225x1	225		1620												
HLR-12A-F/F-250x1	250		1450							2 1/4"-12 UN	2 1/4"-12 UN		450		
HLR-12A-F/F-300x1	300		1750	300	300	350	250	550 (HFC-550)	1/2" NPTF	ODS 76	ODS 76				
HLR-12A-F/F-350x1	350		2000										450		
HLR-12A-F/F-400x1	400		2300												
HLR-13A-F/F-450x1	450		1800												
HLR-13A-F/F-500x1	500		2000	330	330	350	250	650 (HFC-650)	1/2" NPTF	ODS 76	ODS 76		500		
HLR-13A-F/F-550x1	550		2200												

HORIZONTAL & VERTICAL LIQUID RECEIVERS

Technical Data



The following list includes standard products only.

Upon special request, these standard products can be modified according to the Directive 97/23/EC.

- Sight glass may be reduced or increased according to the requirement.
- Sight glasses may be produced in various dimensions according to the requirement.
- Inlet & Outlet connections can be used in various dimensions and features according to the requirement.
- Liquid level sensor connections can be used according to the requirement.

1/2" NPT connection is used as standard. However, LLS-01 model that is supplied by us uses M20x1.5 coupling sleeves.

Please see the page 45 for further information about the product.

- Different coupling sleeves may be used according to the safety valve that you will use and its connection.

- Products in different volume and design may be produced upon request.

Please contact us for further detail.

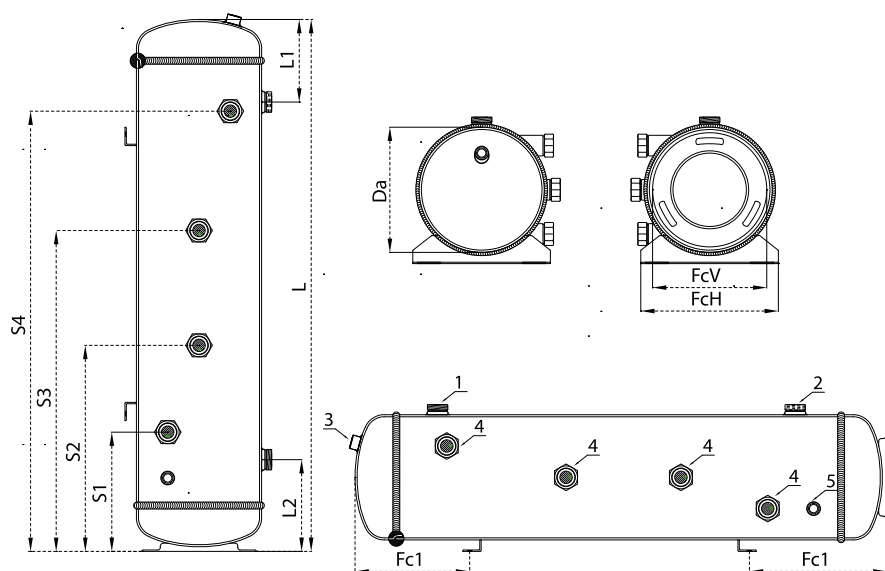

- 1 Inlet Connection
- 2 Outlet Connection
- 3 Safety Valve Connection
- 4 Sight Glass (optional)
- 5 Liquid Level Sensor Connection (optional)

Model	Volume (Lt)	Diameter	Dimensions						Connections			Type	Sight Glass				CE	
			L (mm)	L1 (mm)	L2 (mm)	FcV (mm)	FcH (mm)	Fc1 (mm)	Sv (Inch)	Inlet (Inch)	Outlet (Inch)		S1 (mm)	S2 (mm)	S3 (mm)	S4 (mm)	PED 32 Bar	97/23/EC 45 Bar
HVLR-7D-F/F-20x2	20	Ø219	620	150	150	Ø182 (VFC-182)	240 (HFC-240)	170-230	1/2" NPTF	11/4"-12 UNF	11/4"-12 UNF	SW36	210	450	-	-	CAT I A1	CAT II / A1 B+C1
HVLR-7D-F/F-30x2	30	Ø219	900	150	150	Ø182 (VFC-182)	240 (HFC-240)	250	1/2" NPTF	11/4"-12 UNF	11/4"-12 UNF		230	730	-	-		
HVLR-8D-F/F-40x2	40	Ø219	780	150	150	Ø182 (VFC-182)	240 (HFC-240)	250	1/2" NPTF	11/4"-12 UNF	11/4"-12 UNF		230	580	-	-		
HVLR-8D-F/F-50x2	50	Ø273	960	180	200	Ø249 (VFC-249)	300 (HFC-300)	200-250	1/2" NPTF	1 3/4"-12 UNS	1 1/4"-12		260	770	-	-	CAT III B+C1	CAT III B+C1
HVLR-8D-F/F-60x3	60	Ø273	1160	180	200	Ø249 (VFC-249)	300 (HFC-300)	300	1/2" NPTF	1 3/4"-12 UNS	1 3/4"-12 UNS	1 3/4" Rotolock Sight Glass	260	560	960	-		
HVLR-8D-F/F-70x3	70	Ø273	1350	180	200	Ø249 (VFC-249)	300 (HFC-300)	300	1/2" NPTF	1 3/4"-12 UNS	1 3/4"-12 UNS		300	660	1150	-		
HVLR-9D-F/F-80x3	80	Ø324	1110	220	240	Ø320 (VFC-320)	350 (HFC-350)	300	1/2" NPTF	2 1/4"-12 UN	1 3/4"-12 UNS		260	540	860	-	CAT IV B+D	CAT IV B+D
HVLR-9D-F/F-90x3	90	Ø324	1250	220	240	Ø320 (VFC-320)	350 (HFC-350)	300	1/2" NPTF	2 1/4"-12 UN	1 3/4"-12 UNS	1 3/4" Rotolock Sight Glass	260	580	1000	-		
HVLR-9D-F/F-100x3	100	Ø324	1400	220	240	Ø320 (VFC-320)	350 (HFC-350)	300	1/2" NPTF	2 1/4"-12 UN	1 3/4"-12 UNS		260	660	1150	-		
HVLR-9D-F/F-125x3	125	Ø406	1730	250	330	Ø430 (VFC-430)	450 (HFC-450)	350	1/2" NPTF	2 1/4"-12 UN	2 1/4"-12		260	760	1480	-		
HVLR-10D-F/F-150x3	150	Ø406	1330	250	330	Ø430 (VFC-430)	450 (HFC-450)	350	1/2" NPTF	2 1/4"-12 UN	2 1/4"-12 UN	1 3/4" Rotolock Sight Glass	320	630	1070	-	CAT IV B+D	CAT IV B+D
HVLR-10D-F/F-225x4	225	Ø406	2000	250	330	Ø430 (VFC-430)	450 (HFC-450)	350	1/2" NPTF	2 1/4"-12 UN	2 1/4"-12 UN		320	630	1070	1740		

HORIZONTAL LIQUID RECEIVERS



The following list includes standard products only.
Upon special request, these standard products can be modified according to the Directive 97/23/EC.

- Sight glass may be reduced or increased according to the requirement.
- Sight glasses may be produced in various dimensions according to the requirement.
- Inlet & Outlet connections can be used in various dimensions and features according to the requirement.
- Liquid level sensor connections can be used according to the requirement. 1/2"NPT connection is used as standard. However, LLS-01 model that is supplied by us uses M20x1.5 coupling sleeves.

Please see the page 45 for further information about the product.

- Different coupling sleeves may be used according to the safety valve that you will use and its connection.
- Plates may be made in special dimensions upon request.

- Products in different volume and design may be produced upon request. Please contact us for further detail.

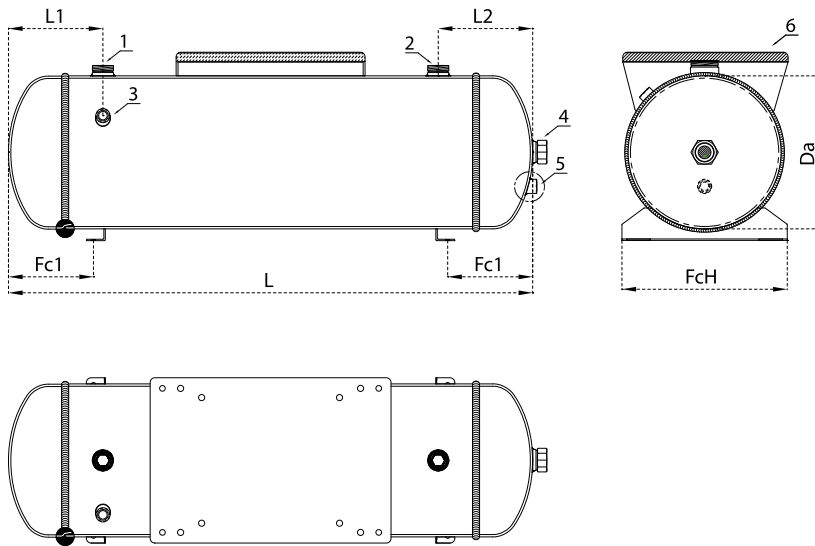

- 1 Inlet Connection
- 2 Outlet Connection
- 3 Safety Valve Connection
- 4 Sight Glass (optional)
- 5 Liquid Level Sensor Connection (optional)
- 6 Plate For Compressor

Model	Volume (Lt)	Diameter	Dimensions					Connections			Sight Glasses	CE		
			L (mm)	L1 (mm)	L2 (mm)	L3 (mm)	Fc1 (mm)	Fc (mm)	Sv (Inch)	Inlet (Inch)		Outlet (Inch)	PED	97/23/EC
													32 Bar	45 Bar
HLR-7D-F/F-30x1	30	ø 219	900	120	120	120	120	240 (HFC-240)	1/2" NPTF	1 1/4"-12 UNF	1 1/4"-12 UNF	SW36	CAT II /A1	CAT II /A1
HLR-7D-F/F-40x1	40		1050	140	140	140				1 3/4"-12 UNS	1 3/4"-12 UNS			
HLR-8D-F/F-50x1	50	ø 273	970	130	130	130	150	300 (HFC-300)	1/2" NPTF	1 3/4"-12 UNS	1 3/4"-12 UNS	13/4" Rotalock Sight Glass	CAT III B+C1	CAT III B+C1
HLR-8D-F/F-60x1	60		1160	150	150	150								
HLR-8D-F/F-70x1	70		1350	180	180	180								
HLR-9D-F/F-80x1	80	ø 324	1110	200	200	200	180	350 (HFC-350)	1/2" NPTF	2 1/4"-12 UN	1 3/4"-12 UNS	13/4" Rotalock Sight Glass	CAT III B+C1	CAT IV B+D
HLR-9D-F/F-90x1	90		1250	220	240	240								
HLR-9D-F/F-100x1	100		1400											

LIQUID RECEIVER WITH SUCTION LINE ACCUMULATORS

Technical Data



The following list includes standard products only.

Upon special request, these standard products can be modified according to the Directive 97/23/EC.

- Sight glass may be reduced or increased according to the requirement.
- Sight glasses may be produced in various dimensions according to the requirement.
- Inlet & Outlet connections can be used in various dimensions and features according to the requirement.
- Liquid level sensor connections can be used according to the requirement.

1/2"NPT connection is used as standard. However, LLS-01 model that is supplied by us uses M20x1.5 coupling sleeves.

Please see the page 45 for further information about the product.

• Different coupling sleeves may be used according to the safety valve that you will use and its connection.

• Products in different volume and design may be produced upon request.

Please contact us for further detail.

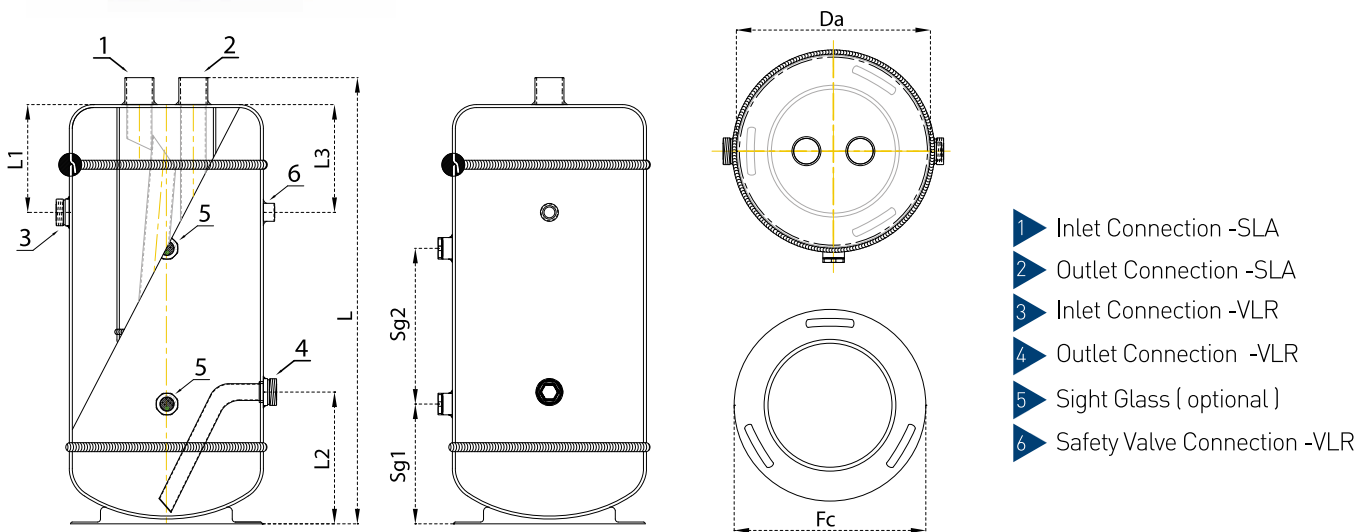

Model	VLR Volume (Lt)	SLA Volume (Lt)	Diameter	Dimensions					Connections			Type	Sight Glasses		CE			
				L (mm)	L1 (mm)	L2 (mm)	L3 (mm)	Fc (mm)	Sv (Inch)	Inlet (Inch)	Outlet (Inch)		S1 (mm)	S2 (mm)	PED 32 Bar	97/23/EC 45 Bar		
VLR-SLA-6/19x1	6	1,7	Ø219	282	80	120	-	Ø 249 (VFC-249)	-	1"-14 UNS	1"-14 UNS	SW36 Screw Sight Glass	120	-	CAT I / A1	CAT II A1		
VLR-SLA-8/22x1	8	3,8		420	80	150	80		1/2" NPTF				1 1/4"- 12 UNF	1 1/4"- 12 UNF			140	-
VLR-SLA-10/22x1	10			480	80	160	80										140	160
VLR-SLA-12/22x1	12			540	100	160	100										140	180
VLR-SLA-16/28x2	16	5,1	Ø273	1050	100	100	Ø 249 (VFC-249)	1 3/4"- 12 UNS		1 3/4"- 12 UNS	140				280	CAT II A1	CAT II A1	
VLR-SLA-20/28x1	20			500	140	180			140		160		-					
VLR-SLA-30/35x2	30	8,1	Ø324	810	180	220	180	Ø 320 (VFC-320)	1 3/4"- 12 UNS	1 3/4"- 12 UNS	160		260	CAT III B+C1	CAT III B+C1			
VLR-SLA-40/42x2	40			745	180	220	180				200		260					
VLR-SLA-50/54x2	50	13,5		1000								200	350					

LIQUID RECEIVERS



The following list includes standard products only.

Upon special request, these standard products can be modified according to the Directive 97/23/EC.

- Sight glass may be reduced or increased according to the requirement.
- Sight glasses may be produced in various dimensions according to the requirement.
- Inlet & Outlet connections can be used in various dimensions and features according to the requirement.

- Liquid level sensor connections can be used according to the requirement.

1/2"NPT connection is used as standard. However, LLS-01 model that is supplied by us uses M20x1.5 coupling sleeves.

Please see the page 45 for further information about the product.

- Different coupling sleeves may be used according to the safety valve that you will use and its connection.

- Products in different volume and design may be produced upon request.

Please contact us for further detail.

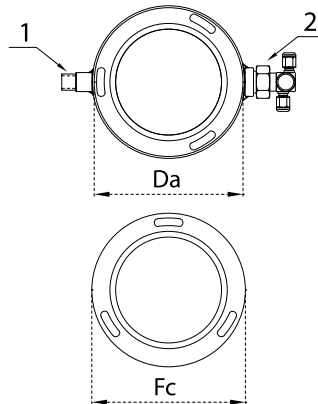
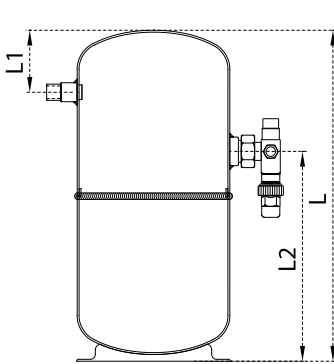

- 1 Inlet Connection
- 2 Outlet Connection

Vertical Liquid Receivers [Deep Drawn]

Model	Volume (Lt)	Dimensions					Connections			<div>CE</div> <div>97/23/EC 32 Bar</div>
							Inside	Outside		
		Da (mm)	L (mm)	L1 (mm)	L2 (mm)	Fc (mm)	Solder	Rotolock Connection	Rotolock Valve	
VLR-01	1	Ø 89	200	45	140	Ø 135 (VFC-135)	1/4"ODS	1"Rot.	1/4" ODS	SEP
VLR-02	2	Ø 120	210	50			3/8"ODS	1"Rot.	3/8"ODS	CAT I A1
VLR-03	3	Ø 140	228	55						
VLR-04	4		298	60	185					
VLR-05	5		Ø 160	297	185	Ø 161 (VFC-161)	1/2"ODS	1"Rot.	1/2"ODS	
VLR-06	6	347		65	220					
VLR-08	8	Ø 180		380	80					240
VLR-09	9		410	255						
VLR-10	10		460	270						
VLR-12	12	Ø 219	360	220	250	5/8"ODS	1"Rot.	5/8"ODS	CAT II A1	
VLR-14	14		410							
VLR-16	16		480							290
VLR-18	18		540							210
VLR-21	21		610							

FOOT CONNECTIONS



Technical Data

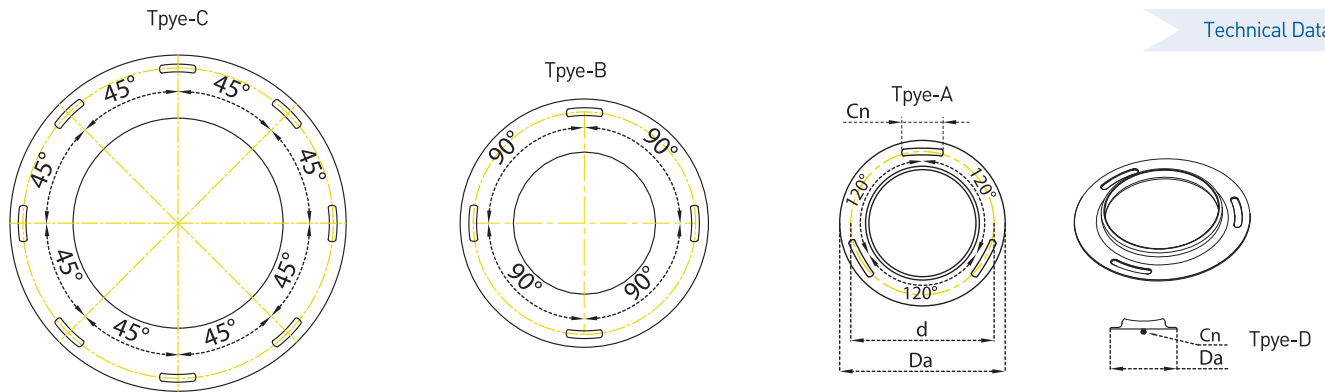

Model	Dimensions		Connection	Type
	Da (mm)	d (mm)	Cn (mm)	
VFC-130	Ø 130	-	M8	D
VFC-135	Ø 135	Ø 107	30*8	A
VFC-161	Ø 161	Ø 153	30*8	A
VFC-182	Ø 182	Ø 166	30*13	A
VFC-249	Ø 249	Ø 214	60*13	A
VFC-320	Ø 320	Ø 277	80*13	A
VFC-430	Ø 430	Ø 380	70*15	B
VFC-480	Ø 480	Ø 430	70*15	B
VFC-550	Ø 550	Ø 500	70*15	B
VFC-650	Ø 650	Ø 600	70*15	C

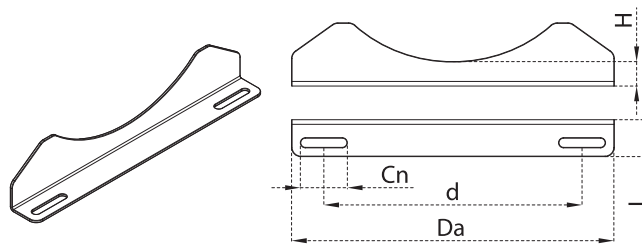

Model	Dimensions			Connection
	Da (mm)	d (mm)	L	Cn (mm)
HFC-135	135	175	40	40*10
HFC-155	155	95	40	40*10
HFC-175	175	115	40	40*10
HFC-240	240	180	40	40*10
HFC-300	300	230	40	50*10
HFC-350	350	280	40	50*10
HFC-450	450	360	60	60*15
HFC-500	500	410	60	60*15
HFC-550	550	460	60	60*15
HFC-650	650	560	80	60*15



Rotalock Valve ;

Rotalock Valves are generally used for turning on and off the inlets and outlets of the receivers.

They can be used in all models of receivers.
They are easily installed and used.

Make sure that rotalock valves function in due manner before installing them.

Model	Body (mm)	Connections	
		Rotalock Connection	Inlet Connection
RVA-1/4	20	3/4"	1/4" ODS
RVA-3/8	20	1"	3/8" ODS
RVA-1/2	20	1"	1/2" ODS
RVA-5/8	20	1"	5/8" ODS
RVA-3/4	22	1 1/4"	3/4" ODS
RVA-7/8	22	1 1/4"	7/8" ODS
RVA-1 1/8	30	1 3/4"	1 1/8" ODS
RVA-1 3/8	30	1 3/4"	1 3/8" ODS
RVA-1 5/8	30	1 3/4"	1 5/8" ODS
RVA-1 5/8	50	2 1/4"	1 5/8" ODS
RVA-2 1/8	50	2 1/4"	2 1/8" ODS



Rotalock Pipe ;

Rotalock pipes are generally used for turning on and off the inlets and outlets of the receivers.

They can be used in all models of receivers.
They are easily installed and used.

Model	Body (mm)	Connections	
		Rotalock Connection	Inlet Connection
RP-1/4	20	3/4"	1/4" ODS
RP-3/8	20	1"	3/8" ODS
RP-1/2	20	1"	1/2" ODS
RP-5/8	20	1"	5/8" ODS
RP-3/4	22	1 1/4"	3/4" ODS
RP-7/8	22	1 1/4"	7/8" ODS
RP-1 1/8	30	1 3/4"	1 1/8" ODS
RP-1 3/8	30	1 3/4"	1 3/8" ODS
RP-1 5/8	30	1 3/4"	1 5/8" ODS
RP-1 5/8	50	2 1/4"	1 5/8" ODS
RP-2 1/8	50	2 1/4"	2 1/8" ODS

SIGHT GLASSES



Sight glasses are used for monitoring the flow and the level of the liquid in the liquid receiver. You can easily observe the level of the liquid by the ball inside.

Rotolock Sight Glasses can be used in every kind of product. Thanks to its rotolock quality, this product we offer is very easily installed. A ball and a plastic tube are used with the rotolock sight glass.

Sight glasses are used for displaying the level of liquids in tanks, collectors, crankcases etc.

The angle valves are designed and dimensioned in accordance withj DIN EN 12178:2004-02 and correspond to ROHS 2002/95 EC (Directive for the Restriction of Hazardous Substances) as well as to the Pressure Equipment Directive 97/23/EC

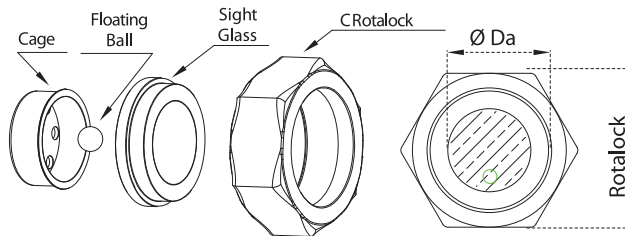

Rotolock Sight Glass / With Swimming Ball		
Model	Da	Rotalock
Sg-1 3/4"	27	1 3/4"
Sg-2 1/4"	38	2 1/4"

1.1/8"-18UNEF

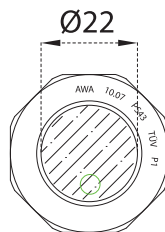
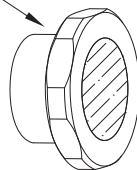

Product	
SW36	Screw-In Sight Glass / With Swimming Ball / 1 1/8-18 UNEF
Parameters	
Ts(°C)	-10°C + 120°C
Ps(bar)	42 bar
Ts(°C)	-50°C + 10°C
Ps(bar)	23 bar
Media r	Refrigerant pursuant to EN 378-1



Description ;

This Oil Level Sensor is designed as a oil/liquid level switch to be used in compressors, receivers and vessels. The sensor output is a relay switch contact.

This optoelectronic Oil Level Sensor, is based on infrared LED and a light receiver. Infrared light reflection/refraction at prism depending from oil level controls the circuit (relay).

The separate design of the electronic module allows the replacement in case of any malfunction.

To insure high ambient operating temperature most electronic parts are selected according to the 'industrial' standard (enhanced temperature range).

Functional Specification

After a power on delay the sensor relay switches on, if liquid level has been detected.

If the sensor detects a low oil level, the relay will switch off.

In every case of status change (i.e. enough oil / low oil) the sensor will recheck the status for about 3 seconds before reacting. This 'delay' prevents the sensor from overacting, i.e. in case of liquid bubbles, etc.

The red LED remains 'ON' if the sensor detects enough liquid. The red LED is flashing during low liquid level.

Electrical Specification

Operating Power,	AC 50/60Hz 230V
Motor Power Sense Line Voltage	AC 50/60Hz 230V
Ambient Temperature Range	-30°C.....+85°C
Maximum Temperature at Prism	+120°C
Delay on power on	1 second
Delay until relay off from detection of liquid loss	3 second
Relay rating data	5A/250V AC
Connection Cable 5x0.5mm ²	length=1 meter,color coded

Mechanical Specification

Steel Housing Material (prism and electronic unit holder)	9SMn28
Prism Material	Fused Glass
Test Pressure	100 bar
Unit Mounting	M20 x 1.5
Weight of steel housing	appr.80g
Weight of electronic module	appr. 80g
Protection Class	IP54

SAFETY VALVES



Safety Valves



Model	Working Pressure	Connection	
		NPT Connection	SAE Connection
3060/23C	28 Bar & 32 Bar	1/4" NPT	3/8" SAE
3060/24C	28 Bar & 32 Bar	1/4" NPT	1/2" SAE
3060/33C	28 Bar & 32 Bar	3/8" NPT	3/8" SAE
3060/34C	28 Bar & 32 Bar	3/8" NPT	1/2" SAE
3060/45C	28 Bar & 32 Bar	3/8" NPT	5/8" SAE

Safety Valves



Model	Working Pressure	Connection	
		NPT Connection	SAE Connection
3030/44C	28 Bar & 32 Bar	1/2" NPT	3/4" G
3030/66C	28 Bar & 32 Bar	3/4" NPT	3/4" SAE
3030/88C	28 Bar & 32 Bar	1" NPT	1 1/4" SAE

Changeover Devices For Safety Valves



Model	Designed For Valve	Connection	
		Connection For The Tank	Connection For The Safety Valve
3030/44C	28 Bar & 32 Bar	1/2" NPT	1/2" NPT
3030/66C	28 Bar & 32 Bar	3/4" NPT	1/2" NPT
3030/88C	28 Bar & 32 Bar	3/4" NPT	3/4" NPT

Products	Allowable Temperature		Allowable Pressure
	TS	Working Pressure	Testing Pressure
	min. / max.	PS (bar)	PT (bar)
Liquid Receivers	- 20 / + 130	33 Bar	48 Bar
Liquid Receivers (deep drawing)	- 10 / + 110	33 Bar	48 Bar
Suction Line Accumulators	- 40 / + 110	33 Bar	48 Bar
Suction Line Accumulators With Exc.	- 40 / + 110	33 Bar	48 Bar
H48 Filter Drier Shells	- 40 / + 80	33 Bar	48 Bar
Oil Reservoirs	- 10 / + 130	33 Bar	48 Bar
Oil Level Regulators	- 10 / + 130	33 Bar	48 Bar
Oil Strainer	- 10 / + 130	33 Bar	48 Bar
Mufflers	- 10 / + 120	33 Bar	48 Bar

CE 97/23/EC	
Category	Modul
SEP	No need CE
Cat I	A
Cat II	A1
Cat III	B+C1
Cat IV	B+D

DIMENSION	
3/4"	3/4" -14 UNF
1"	1" -14 UNS
1 1/4"	1 1/4" - 12 UNF
1 3/4"	1 3/4" - 12 UNS
2 1/4"	2 1/4" - 12 UN

Products	Paint Code (RAL)
Liquid Receivers	RAL 9005 (Mat)
Liquid Receivers (deep drawing)	
Suction Line Accumulators	
Suction Line Accumulators With Exc.	
Mufflers	
H48 Filter Drier Shells	RAL 5009
Oil Reservoirs	
Oil Level Regulators	
Oil Strainer	

Connection For Pressure Relief Valve
1/4"-18 NPTF
3/8"-18 NPTF
1/2"-14 NPTF

CONNECTION PARTS	
Category	Modul
(mm)	(inch)
6 mm	1/4"
10 mm	3/8"
12 mm	1/2"
16 mm	5/8"
19 mm	3/4"
22 mm	7/8"
28 mm	1 1/8"
35 mm	1 3/8"
42 mm	1 5/8"
54 mm	2 1/8"
66 mm	2 5/8"
76 mm	3 1/8"
105 mm	4 1/8"

Connection For Rot. Valve	Rotolock Valves
3/4"	1/4" Rotolock Valve
1 "	1/4" Rotolock Valve
	3/8" Rotolock Valve
	1/2" Rotolock Valve
1 1/4 "	5/8" Rotolock Valve
	3/4" Rotolock Valve
	7/8" Rotolock Valve
1 3/4 "	1 1/8" Rotolock Valve
	1 3/8" Rotolock Valve
	1 5/8" Rotolock Valve
2 1/4 "	1 5/8" Rotolock Valve
	2 1/8" Rotolock Valve

PRODUCTION



Our Production Flow Chart

Entry Control

- All the raw materials we use are certified.
- After passing through the entry controls, the raw materials are stored in our warehouses.

Production

- Our products are cut and sized by full automatic band saw machine tools.
- The connectors of our products are perfectly processed by CNC lathes.
- The holes in the connectors of our products are carefully measured and drilled.
- Our products are welded without human touch by automatic (gas metal arc) welding machines.

Testing (Blasting / Measurement-Eye-Hand / Impermeability Tests)

The First Phase (Blasting)

In the first phase, several samples arbitrarily taken from among the mass produced output are chosen, and these samples are firstly subjected to the blasting test. (The blasting test machine is of 600 bars.)

In the blasting test, the changes in the product's shape which occur as the pressure is increased are controlled and recorded.

In addition, we monitor the color changes, thus controlling both the product's metal plate (raw material) and color endurance.

The Second Phase (Measurement-Eye-Hand)

In the second phase, we subject the products to a Measurement-Eye-Hand Test. Depending upon the nature of the defect, the defective products are either sent to the production line for modification or are disposed of before they are subjected to the impermeability test. (Each product is tested.)

The Third Phase (Impermeability)

In the third and the last phase, all products are exposed to the impermeability test. The impermeability test is implemented by means of compressed air and water. The products that cannot pass the impermeability test are either sent to the production line for modification or are disposed of depending upon the nature of the defect.

Clean-up

- Both interior and exterior surfaces of the products are phosphatized.

Painting

- All of our products are painted with a system of automatic electrostatic powder dying.
- Thanks to our automatic electrostatic powder dying of 45 and 24 meters cabin, which works with a rail system, our products are dyed in a very healthy way.

Installation

- After the connection entries of the products are cleaned, required particles such as rotolock valves, sight glasses, safety valves and blind flanges (upon request) are installed by using gaskets and O rings.

Labeling & Packaging

- Our products and their packages are print labeled with automatic barcode machines. Each product is packaged separately.
- In every package, there are white papers which include assembly instructions/warnings and general information about the products.
- After each product is packaged, serial products are gathered in groups of 4, 6, 9 and 12 pieces, and stored appropriately ready to be put on the market.

All the processes are recorded carefully.

Our production flow chart is in accordance with the directives of ISO 9001-2008 and CE 97/23/EC.

Contract

1. Our company promises to take back unconditionally all defective products for which we are responsible.

If a problem results from any of the processes below

- Taking the order,
 - Technical drawing,
 - Production,
 - Packaging, etc... for which our company is responsible, returning or changing the products shall be admitted free of charge.
-) If you request to return the products whose defects you are responsible for;
- 7 % variance shall be applied for our standard products.
 - In case of special products, the percentage shall be decided according to the usability of the product.
 - Very special custom made products shall not be taken back.

2. Our products are guaranteed for three years from the date of invoice.

- The label of the product should not be damaged (legibility is enough).
- Our company does not take back the products damaged in the course of transportation unless a special contract is made.
- Products that are kept outdoors or under damp conditions shall not be included under conditions of guarantee.

3. Production

- Products in our lists are standard.
- Special products are manufactured upon request.
- The return of special custom made products is not admitted.

4. Our products are delivered ex works.

- Products of small scale can be delivered to stores as well (maximum 50 pieces).
- Products to be delivered to stores take one or two days for delivery.

5. Testing

- You can participate in the testing processes if you wish.
- You can participate in the periodical blasting tests.
- The blasting tests which are made upon special request shall be priced according to the product and its conditions.

6. Testing

Pricing / Payment

- In standard purchasing, our price list and discount rates about which you are informed shall be applied.
 - Please request a special price for special and large amounts of purchase (minimum 1000 pieces).
 - Special prices shall be applied for group buying.
-) Payments shall be determined in accordance with your purchase and contract.